

- This watch is solar-powered. Expose the dial to light and use it sufficiently charged.
- To see details of charging time, specifications and operations, refer to the instruction manual:  B51* instruction manual

Component identification

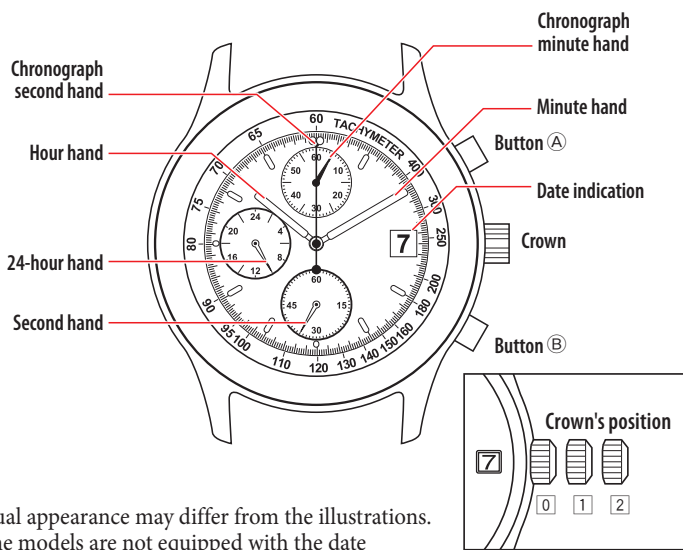

- Actual appearance may differ from the illustrations.
- Some models are not equipped with the date indication.
- The crown has two positions when pulling it out.
- Refer also to our web page for detail of usage of the scale and bezel on the watch. (<http://www.citizenwatch-global.com/support/pdf/enhanced/e.pdf>)

Charging by swinging the watch

In addition to exposing to light, this watch is charged by moving the arm wearing it.

Efficient swing to charge the watch

Swing the watch back and forth in the range of 20 - 25 cm (8 - 10 inches) at the rate of 2 - 2.5 times per second.

- About 300 - 500 times of swing-back-and-forth are required to restart the watch when it is stopped.
- To see details of charging by swinging the watch, refer to the instruction manual.

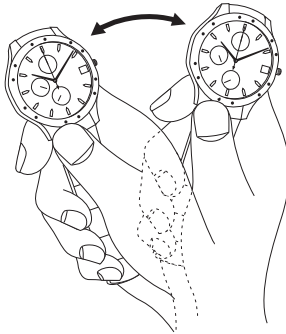

Setting the time

1. Pull the crown out to position 2 when the second hand points 0 second.

The second hand stops.

2. Rotate the crown to set the time.

- Check whether the time set is AM or PM with the 24-hour hand.
- Move the hands 4 or 5 minutes forward and move them back to the right time to set the time more precisely.

3. Push the crown in to position 0 in accordance with a reliable time source.

Setting the date

- Do not adjust the date indication while the watch shows 9:00 PM - 1:00 AM. Otherwise, the date indication may change incorrectly thereafter.
- Date indication adjustment is required on the first days of March, May, July, October and December.

1. Pull the crown out to position 1.

2. Rotate the crown counterclockwise to set the date indication.

- Clockwise rotation moves nothing.

3. Push the crown in to position 0 to finish the procedure.

Adjusting the 0 position of the chronograph second hand

Adjust the position of the chronograph second hand when it does not return to the 0 position after resetting the chronograph or it settles at a wrong position due to strong shock or other causes.

1. Pull the crown out to position 2.

2. Press and release the upper right button (A) repeatedly to adjust the chronograph second hand to the 0 position.

- Pressing and holding the button moves the hand continuously.

3. Set the time and push the crown in to position 0.

4. Press and release the lower right button (B).

- The chronograph minute and second hands return to the 0 position. If not, repeat steps 1 - 3.
- Adjust the time after finishing the 0-position adjustment.